

Digital Still Camera

Operating Instructions

Before operating the unit, please read this manual thoroughly, and retain it for future reference.

Owner's Record

The model and serial numbers are located on the bottom. Record the serial number in the space provided below. Refer to these numbers whenever you call upon your Sony dealer regarding this product.

Model No. _____

Serial No. _____

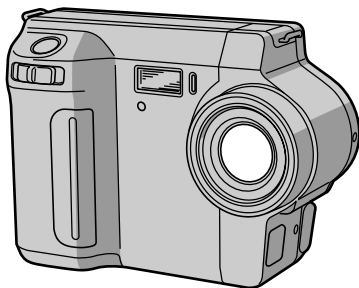

FD Mavica

MVC-FD87



WARNING

To prevent fire or shock hazard, do not expose the unit to rain or moisture.

For the Customers in the U.S.A.

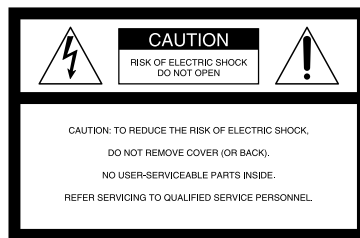

This symbol is intended to alert the user to the presence of uninsulated “dangerous voltage” within the product’s enclosure that may be of sufficient magnitude to constitute a risk of electric shock to persons.



This symbol is intended to alert the user to the presence of important operating and maintenance (servicing) instructions in the literature accompanying the appliance.

CAUTION

You are cautioned that any changes or modifications not expressly approved in this manual could void your authority to operate this equipment.

Note:

This equipment has been tested and found to comply with the limits for a Class B digital device, pursuant to Part 15 of the FCC Rules. These limits are designed to provide reasonable protection against harmful interference in a residential installation. This equipment generates, uses, and can radiate radio frequency energy and, if not installed and used in accordance with the instructions, may cause harmful interference to radio communications. However, there is no guarantee that interference will not occur in a particular installation. If this equipment does cause harmful interference to radio or television reception, which can be determined by turning the equipment off and on, the user is encouraged to try to correct the interference by one or more of the following measures:

- Reorient or relocate the receiving antenna.
- Increase the separation between the equipment and receiver.
- Connect the equipment into an outlet on a circuit different from that to which the receiver is connected.
- Consult the dealer or an experienced radio/TV technician for help.

For the Customers in the U.S.A. and Canada

DISPOSAL OF LITHIUM ION BATTERY.

LITHIUM ION BATTERY.

DISPOSE OF PROPERLY.

You can return your unwanted lithium ion batteries to your nearest Sony Service Center or Factory Service Center.

Note:

In some areas the disposal of lithium ion batteries in household or business trash may be prohibited.

For the Sony Service Center nearest you call 1-800-222-SONY (United States only)

For the Sony Factory Service Center nearest you call 416-499-SONY (Canada only)

Caution:

Do not handle damaged or leaking lithium ion battery.



For the Customers in Canada

CAUTION

TO PREVENT ELECTRIC SHOCK, DO NOT USE THIS POLARIZED AC PLUG WITH AN EXTENSION CORD, RECEPTACLE OR OTHER OUTLET UNLESS THE BLADES CAN BE FULLY INSERTED TO PREVENT BLADE EXPOSURE.

NOTICE FOR THE CUSTOMERS IN THE UNITED KINGDOM

A moulded plug complying with BS 1363 is fitted to this equipment for your safety and convenience.

Should the fuse in the plug supplied need to be replaced, a 5 AMP fuse approved by ASTA or BSI to BS 1362, (i.e. marked with  or  mark) must be used.

If the plug supplied with this equipment has a detachable fuse cover, be sure to attach the fuse cover after you change the fuse. Never use the plug without the fuse cover. If you should lose the fuse cover, please contact your nearest Sony service station.

For the Customers in Germany

Directive: EMC Directive 89/336/EEC.92/31/EEC

This equipment complies with the EMC regulations when used under the following circumstances:

- Residential area
- Business district
- Light-industry district

(This equipment complies with the EMC standard regulations EN55022 Class B.)

Attention

The electromagnetic fields at the specific frequencies may influence the picture and sound of this camera.

Be sure to read the following before using your camera

Operating instructions

Before operating the unit, please read this manual thoroughly, and retain it for future reference.

As you read through this manual, buttons and settings on the camera are shown in capital letters.

e.g. Press DISPLAY.

Trial recording

Before you record one-time events, you may want to make a trial recording to make sure that the camera is working correctly.

No compensation for contents of the recording

Contents of the recording cannot be compensated for if recording or playback is not possible due to a malfunction of your camera or recording medium, etc.

Precaution on copyright

Television programs, films, video tapes, and other materials may be copyrighted.

Unauthorized recording of such materials may be contrary to the provision of the copyright laws.

Do not shake or strike the camera

In addition to malfunctions and inability to record images, this may render the floppy disks unusable or image data breakdown, damage or loss may occur.

LCD screen, finder (only models with a finder) and lens

- The LCD screen and the finder are manufactured using extremely high-precision technology, so over 99.99% of the pixels are operational for effective use. However, there may be some tiny black points and/or bright points (white, red, blue or green in color) that constantly appear on the LCD screen and the finder. These points are normal in the manufacturing process and do not affect the recording in any way.
- Be careful when placing the camera near a window or outdoors. Exposing the LCD screen, the finder or the lens to direct sunlight for long periods may cause malfunctions.

Do not get the camera wet

When taking pictures outdoors in the rain or under similar conditions, be careful not to get the camera wet. If moisture condensation occurs, refer to page 51 and follow the instructions on how to remove it before using the camera.

Back up recommendation

To avoid the potential risk of data loss, always copy (back up) data to a disk.

When the camera is used for long periods

Note that the camera body may become hot.

Table of contents

Introduction	6
--------------------	---

Getting started

Identifying the parts	7
Preparing the power supply	9
Setting the date and time	13
Inserting a floppy disk	15

Basic operations

► Recording

Recording images	16
------------------------	----

► Playback

Playing back images	21
Viewing images using a computer	22
Image file storage destinations and image file names	24

Advanced operations

Before performing advanced operations

How to use the PLAY/STILL selector	26
How to use the control button	26
How to change the menu settings	28

► Various recording

Setting the image size (IMAGE SIZE)	33
Recording images for e-mail (E-MAIL)	34
Recording text documents (TEXT)	34
Recording images in macro	35
Setting the distance to the subject	35
Using the PROGRAM AE function	36
Adjusting the exposure (EXPOSURE)	38

Adjusting the white balance (WHITE BALANCE)	39
Recording the date and time on the image (DATE/TIME)	40
Enjoying picture effects (PICTURE EFFECT)	40

► Various playback

Playing back six images at once (INDEX)	41
Enlarging a part of the image (Zoom and trimming)	42
Playing back the images in order (SLIDE SHOW)	43

► Editing

Preventing accidental erasure (PROTECT)	44
Deleting images (DELETE)	45
Changing the recorded image size (RESIZE)	46
Copying images (COPY)	46
Copying all the information on your floppy disk (DISK COPY)	48
Selecting images to print (PRINT MARK)	49
Format	50

Additional information

Precautions	51
On "Memory Sticks"	53
Using your camera abroad	53
About "InfoLITHIUM" battery pack	54
Troubleshooting	56
Warning and notice messages	60
Self-diagnosis display	62
Specifications	63
LCD screen indicators	64
Index	66

Introduction

Deletes undesired images right away, checking the image after shooting

The digital still camera is able to play back the image and delete it right away.

Recording images:

page 16

Playing back images:

page 21

Deleting images

(DELETE): page 45

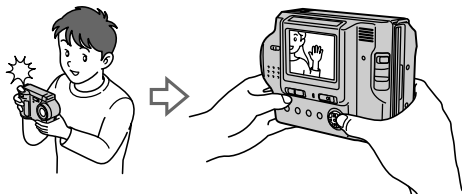

Captures images with your computer

You can easily copy images onto your computer using a floppy disk, and view and modify images on your computer using application software.

Viewing images using a computer: page 22

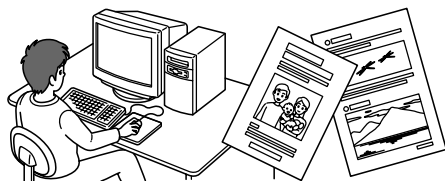

Selects the recording mode from various types of recordings for your situation

Recording images for e-mail (E-MAIL): page 34

Recording text documents (TEXT): page 34

Identifying the parts

See the pages in parentheses for details of operation.

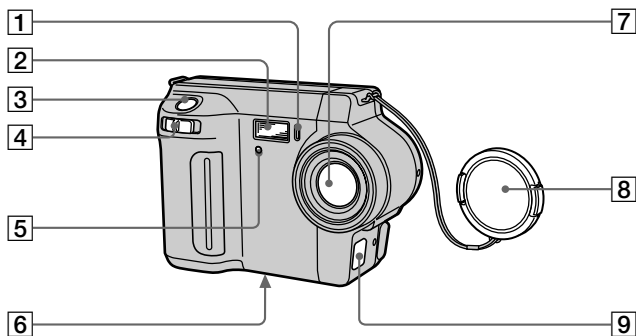

1 Self-timer lamp (19)

2 Flash (20)

3 Shutter button (16)

4 Zoom lever (18)

5 Photocell window for flash

Do not block while recording.

6 Tripod receptacle (bottom surface)

Use a tripod with a screw length of less than 6.5 mm (7/32 inch). You cannot firmly secure the camera to tripods having longer screws, and may damage the camera.

7 Lens

8 Lens cap (supplied)

9 DC IN cover/DC IN jack (10, 12)

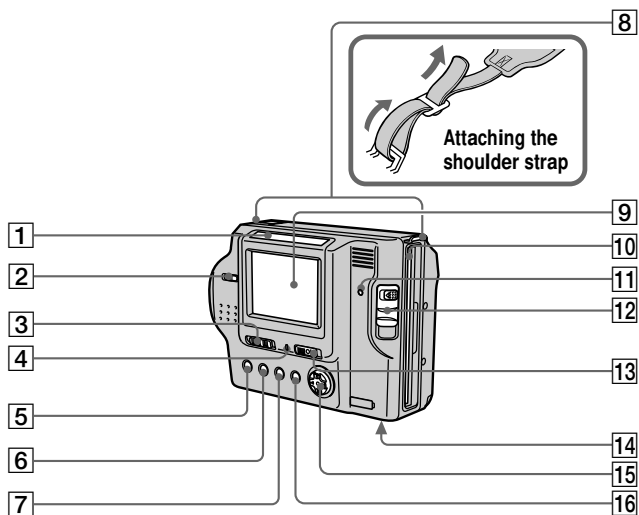

- | | |
|---|--|
| <p>1 Photocell window for LCD screen
The LCD screen becomes brighter when exposed to sunlight.</p> <p>2 LCD BACKLIGHT switch (18)</p> <p>3 PLAY/STILL selector (16, 21, 26)</p> <p>4 POWER ON/OFF (CHG) (Charge) lamp (10, 13)</p> <p>5 $\frac{1}{2}$ (Flash) button/ $\frac{1}{2}$ (Flash) lamp (20)</p> <p>6 FOCUS button (35)</p> <p>7 PROGRAM AE button (36)</p> | <p>8 Hooks for strap</p> <p>9 LCD screen</p> <p>10 Floppy disk slot (15)</p> <p>11 Access lamp (16, 17)</p> <p>12 DISK EJECT lever (15)</p> <p>13 POWER switch (13)</p> <p>14 Battery cover (9)</p> <p>15 Control button (13, 26)</p> <p>16 DISPLAY button (19)</p> |
|---|--|

Preparing the power supply

Installing the battery pack

Your camera operates only with the NP-F330 (supplied)/F550 (not supplied) “InfoLITHIUM” battery pack* (L series). See page 54 for more information about “InfoLITHIUM” battery pack.

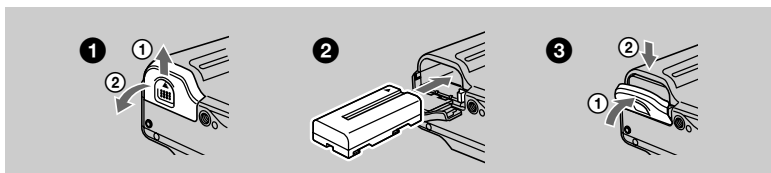

- 1 Open the battery cover.**
Slide the battery cover in the direction of the arrow.
- 2 Install the battery pack.**
Insert the battery pack with the ▲ mark facing toward the battery compartment as illustrated.
- 3 Close the battery cover.**

To remove the battery pack

Open the battery cover. Slide the battery eject lever rightward, and remove the battery pack.

Be careful not to drop the battery pack when removing it.



Battery eject lever

* What is “InfoLITHIUM”?

“InfoLITHIUM” is a lithium ion battery pack which can exchange information such as battery consumption with compatible video equipment. “InfoLITHIUM” L series battery packs have the

InfoLITHIUM mark. “InfoLITHIUM” is a trademark of Sony Corporation.

Charging the battery pack

When the camera is turned on, you cannot charge the battery pack. Be sure to turn off the power of the camera.

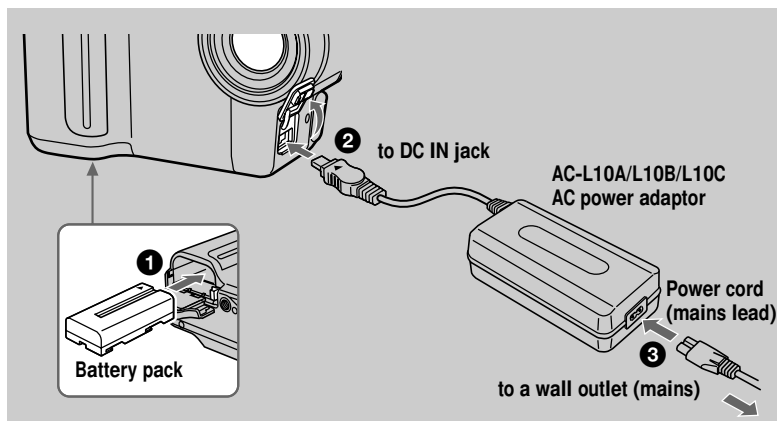

- 1** Insert the battery pack into your camera.
- 2** Open the DC IN cover and connect the AC power adaptor to the DC IN jack of your camera with the ▲ mark facing up.
- 3** Connect the power cord (mains lead) to the AC power adaptor and then to a wall outlet (mains).
The POWER ON/OFF (CHG) lamp (orange) below the LCD screen lights up when charging begins. When the POWER ON/OFF (CHG) lamp goes off, **full charge** is completed.

After charging the battery pack

Disconnect the AC power adaptor from the DC IN jack on your camera.

Battery remaining indicator

The LCD screen on the camera shows the remaining time for which you can still record or play back images.

This indication may not be entirely accurate depending on the conditions of use and the operating environment.

Charging at a room temperature of 10°C to 30°C (50°F to 86°F) is recommended.

NP-F330 (supplied)/F550 (not supplied) battery pack

When you record images in an extremely cold location or using the LCD screen, the operating time becomes short. When using the camera in an extremely cold location, place the battery pack in your pocket or other place to keep it warm, then insert the battery pack into the camera just before recording. When using a pocket heater, take care not to let the heater directly contact the battery.

Auto power-off function

If you do not operate the camera for about three minutes during recording, the camera turns off automatically to prevent wearing down the battery pack. To use the camera again, slide the POWER switch to the right to turn on the camera again.

Note on the POWER ON/OFF (CHG) lamp during charging

The POWER ON/OFF (CHG) lamp may flash:

- When a malfunction occurs in the battery pack (page 59).

The POWER ON/OFF (CHG) lamp does not light up:

- When the battery pack is not installed properly.

Charging time

Battery pack	Full charge (min.)
NP-F330 (supplied)	Approx. 150
NP-F550	Approx. 210

Approximate time to charge a completely discharged battery pack at a temperature of 25°C (77°F).

Battery life and number of images that can be recorded/played back

STILL mode recording/playback

	NP-F330 (supplied)		NP-F550	
	Battery life (min.)	Number of images	Battery life (min.)	Number of images
Continuous recording*	Approx. 70	Approx. 750	Approx. 150	Approx. 1600
Continuous playback**	Approx. 80	Approx. 2200	Approx. 170	Approx. 4800

Approximate battery life and number of images that can be recorded/played back at a temperature of 25°C (77°F) with a fully charged battery pack, 640×480 image size and in NORMAL recording mode.

* Recording at about 5-second intervals

** Playing back single images continuously at about 2-second intervals

Notes

- The battery life and number of images will be decreased when using at low temperature, using the flash, turning the power on/off frequently, or using the zoom.
- The capacity of the floppy disk is limited. The above figures are as a guide when you continuously record/play back by replacing the floppy disk.
- If sufficient battery remaining time is indicated but the power runs out soon, fully charge the battery so that the correct battery remaining time appears.
- Do not short the DC plug of the AC power adaptor with a metallic object, as this may cause a malfunction.

Using the AC power adaptor

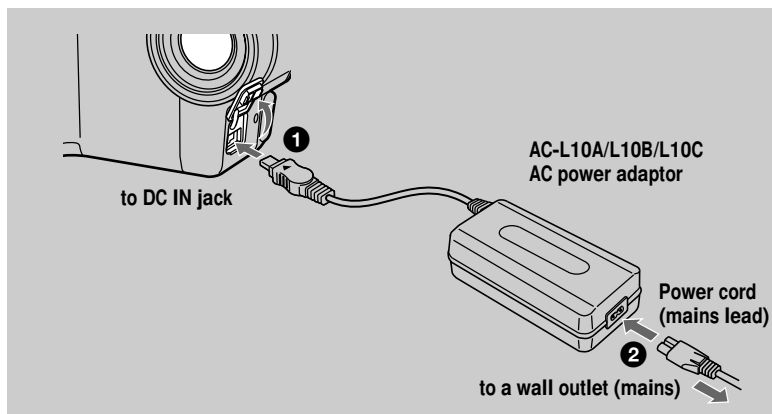

- 1** Open the DC IN cover and connect the AC power adaptor to the DC IN jack of your camera with the ▲ mark facing up.
- 2** Connect the power cord (mains lead) to the AC power adaptor and then to a wall outlet (mains).

Using a car battery

Use Sony DC adaptor/charger.

Using your camera abroad

For details, see page 53.

When using the AC power adaptor

Be sure to use it near a wall outlet. If a malfunction occurs, disconnect the plug from the wall outlet.

Setting the date and time

When you first use your camera, set the date and time. If these are not set, the CLOCK SET screen appears whenever you turn on your camera.

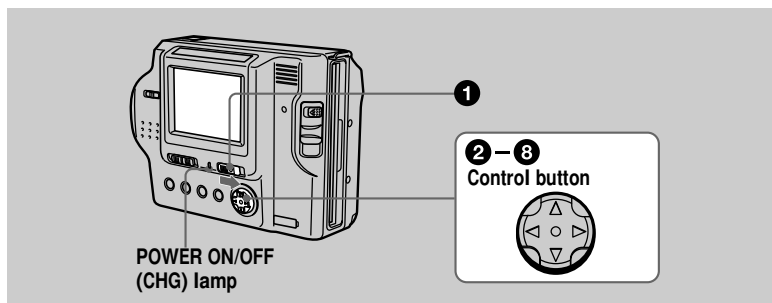

- 1 Slide the **POWER** switch to the right to turn on the power.
The POWER ON/OFF (CHG) (green) lamp lights up.

- 2 Press **▲** on the control button.
The menu bar appears on the LCD screen.

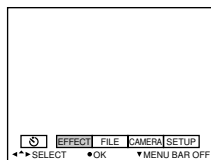

- 3 Select **[SETUP]** with **▶** on the control button, then press the center **●**.

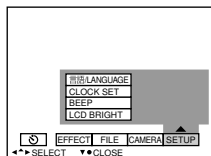

- 4 Select **[CLOCK SET]** with **▲/▼** on the control button, then press the center **●**.

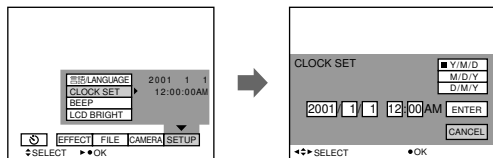

- 5** Select the desired date display format with ▲/▼ on the control button, then press the center ●.

Select from [Y/M/D] (year/month/day), [M/D/Y] (month/day/year), or [D/M/Y] (day/month/year).

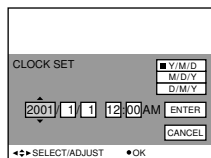

- 6** Select the year, month, day, hour or minute item you want to set with ◀/▶ on the control button.

The item to be set is indicated with ▲/▼.

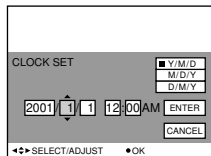

- 7** Set the numeric value with ▲/▼ on the control button, then press the center ● to enter it.

After entering the number, ▲/▼ moves to the next item. If you selected [D/M/Y] in step 5, set the time on a 24-hour cycle.

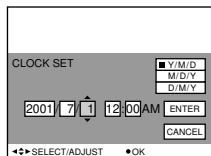

- 8** Select [ENTER] with ▶ on the control button, then press the center ● at the desired moment to begin clock movement.

The date and time are entered.

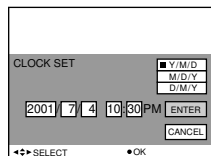

To cancel the date and time setting

Select [CANCEL] with ▲/▼/◀/▶ on the control button, then press the center ●.

Inserting a floppy disk

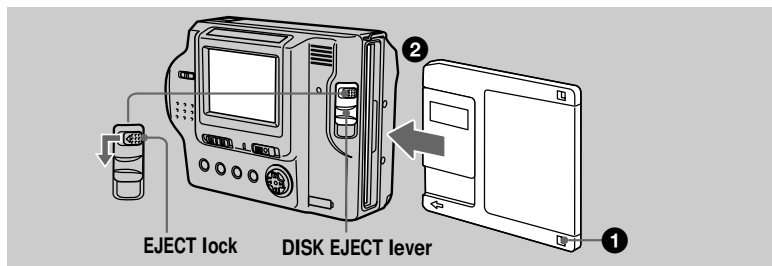

- 1 Check that the write protect tab is set to the recordable position for recording.

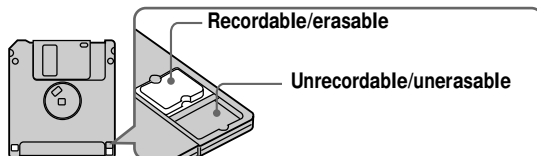

- 2 Insert the floppy disk until it clicks.

Usable floppy disks

- Size: 3.5 inch
- Type: 2HD (1.44 MB)
- Format: MS-DOS format (512 bytes × 18 sectors)

You can use the “Memory Stick”* (not supplied) with inserting it into the MSAC-FD2M/FD2MA Floppy Disk Adaptor for Memory Stick (not supplied), other than floppy disks mentioned above.

* “Memory Stick” and  are trademarks of Sony Corporation.

Notes

- Do not insert the media other than the floppy disks described above.
- Never remove the floppy disk or turn off the power while the access lamp is lit up.

Removing the floppy disk

While sliding the EJECT lock to the left, slide down the DISK EJECT lever.

Recording images

Images are recorded in JPEG format.

To record images, slide the POWER switch to the right to turn on the power and insert a floppy disk.

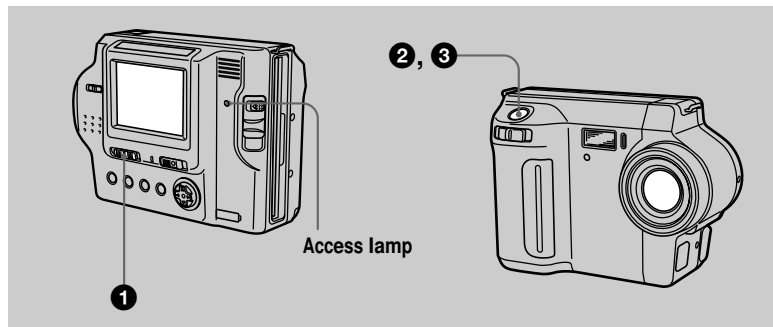

1 Set the PLAY/STILL selector to STILL.

2 Press and hold the shutter button halfway down.

The beeps sound and the image is frozen, however, **the image has not been recorded yet**. While the AE lock indicator ● is flashing, the camera automatically adjusts the exposure and focus of the captured image. When the camera finishes the automatic adjustments, **the AE lock indicator ● stops flashing, then lights up, and the camera is ready for recording**. If you release the shutter button, the recording will be canceled.

AE lock indicator (green)
flashes → lights up

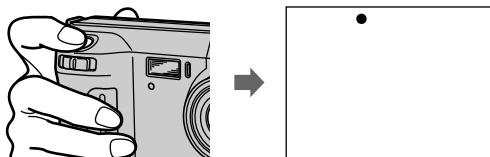

3 Press the shutter button fully down.

The shutter beeps sound. “RECORDING” appears on the LCD screen, and the image will be recorded on the floppy disk. When “RECORDING” disappears from the LCD screen, you can start the next recording.

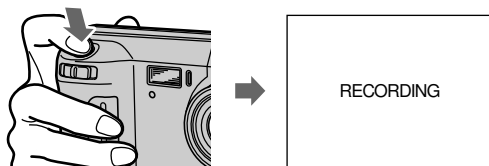
**For the number of images you can record on a floppy disk**

See page 33.

Notes

- When using a “Memory Stick,” writing and reading images take about twice times than using a floppy disk.
- When recording bright subjects, the color of the LCD screen may change after the AE is locked, however, this will not affect the recorded image.
- While the image is being recorded on a floppy disk, the access lamp lights. When this lamp is lit, do not shake or strike the camera. Also, do not turn the power off, or not remove the battery pack/floppy disk. Otherwise, an image data breakdown may occur and the floppy disk may become unusable.
- When you press the shutter button fully down at once, the camera starts recording after the automatic adjustment is complete. However, the recording cannot be carried out while the  lamp (page 8) is flashing. (During this time, the camera is charging the flash.)

Checking the last recorded image (Quick Review)

You can check the last recorded image by clearing the menu bar from the screen (page 27) and pressing ◀ on the control button.

To return to the normal recording mode: press the shutter button lightly, or select [RETURN] with ◀▶ on the control button and then press the center ●.

To delete the image: first select [DELETE] on the Quick Review screen with ◀▶ on the control button and press the center ●, and then select [OK] with ▲▼ on the control button and press the center ●.

Adjusting the brightness of the LCD screen

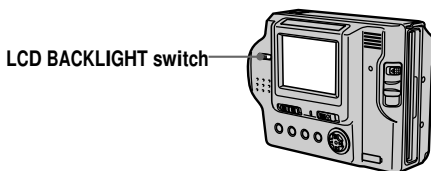

Adjust the brightness with the [LCD BRIGHT] item in the menu settings (page 32). This adjustment does not affect the brightness of the images recorded on the floppy disk.

To turn off the LCD backlight

Set the LCD BACKLIGHT switch to OFF to save the battery.

Using the zoom feature

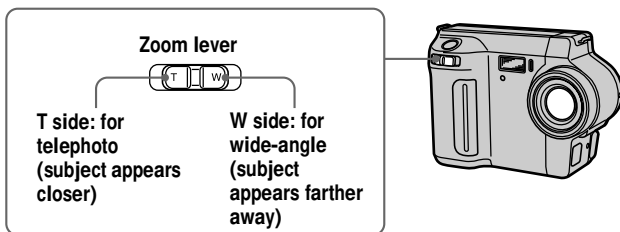

If you cannot get a sharp focus on a close subject

Slide the zoom lever to the W side and move closer to the subject until the focus is sharp (page 35).

Minimum focal distance to the subject

W side: About 25 cm (9 7/8 inches)

T side: About 60 cm (23 5/8 inches)

To record even closer subjects, see page 35.

Digital zoom function

This camera has a digital zoom function.

Digital zoom enlarges the image by digital processing, and it starts to function when the zoom exceeds 3×.

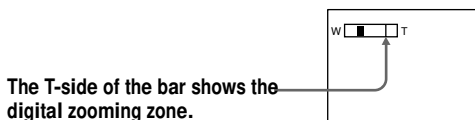

Using digital zoom

- The maximum zoom magnification is 6×.
- Digital zooming deteriorates the picture quality. When digital zoom is not necessary, set [DIGITAL ZOOM] to [OFF] in the menu settings (page 30).

The indicators on the LCD screen during recording

Press DISPLAY to turn on/off the indicators on the LCD screen. See page 64 for a detailed description of the indicators.

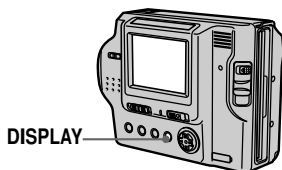





Notes

- You cannot turn off the  (self-timer) indicator and some of the indicators used in advanced operations.
- The indicators on the LCD screen are not recorded.

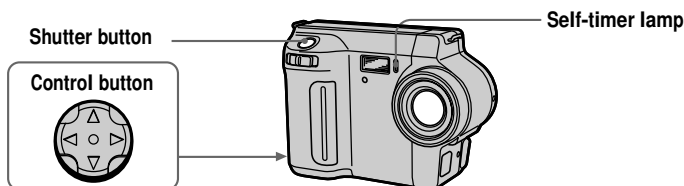
Using the self-timer

When you use the self-timer function, the subject is recorded 10 seconds after you press the shutter button.





Select  on the LCD screen with /▶/▲/▼ on the control button, then press the center . The  (self-timer) indicator appears on the LCD screen, and the subject is recorded 10 seconds after you press the shutter button. The self-timer lamp flashes after you press the shutter button until the image is recorded.

Recording images with the flash

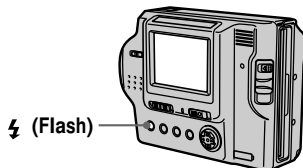
The initial setting is AUTO (no indication). In this mode, the flash automatically strobes when the surroundings become dark. To change the flash mode, press  (Flash) repeatedly so that the flash mode indicator appears on the LCD screen.



Each time you press the button, the indicator changes as follows.

(No indication) →  →  →  → (No indication)

 Auto red-eye reduction : The flash strobes before recording to reduce the red-eye phenomenon.

 Forced flash : The flash strobes regardless of the surrounding brightness.

 No flash : The flash does not strobe.

You can change the amount of the flash light with [FLASH LEVEL] in the menu settings (page 31).

Notes

- The recommended shooting distance is 0.3 to 2.5 m (1 to 8 1/3 feet).
- Attaching a conversion lens (not supplied) may block the light from the flash and the recorded image may be eclipsed.
-  Auto red-eye reduction may not produce the desired red-eye reduction effects depending on individual differences, the distance to the subject, if the subject does not see the pre-strobe, or other conditions.
- The flash effect is not obtained easily when you use forced flash in a bright location.

Playing back images

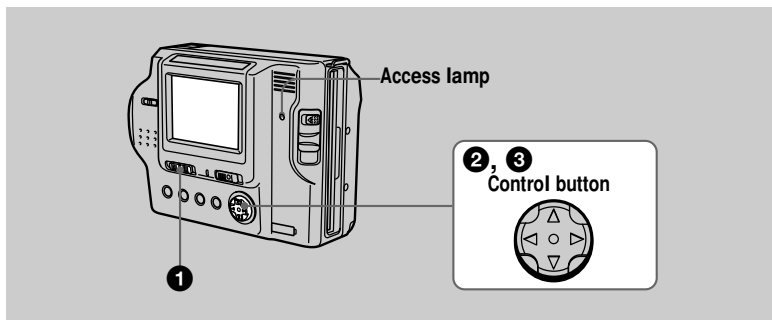

- 1 Set the PLAY/STILL selector to PLAY.**
The last recorded image appears on the LCD screen.
- 2 Press ▲ on the control button to display the menu bar on the LCD screen.**
- 3 Select the desired image with the control button.**
Press ▲/▼/◀/▶ on the control button to select ◀▶ on the LCD screen, then press ◀/▶.
◀: To display the preceding image.
▶: To display the next image.

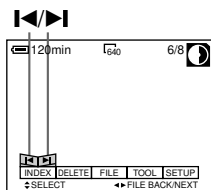

When the menu bar is not displayed

You can directly select and play back the image with ◀▶ on the control button.

Notes

- You might not be able to correctly play back images recorded with this camera on other equipment.
- You may not be able to play back images whose image sizes are larger than the maximum image size that can be used with this camera for recording.

LCD screen indicators during playback

Press DISPLAY to turn on/off the indicators on the LCD screen.
See page 65 for a detailed description of the indicators.

Viewing images using a computer

You can view image data recorded with your camera on a computer, process it using application software, and attach it to an e-mail. This section describes the general method for viewing images on a computer. Be sure to also see the operation manuals for your computer and application software.

Note

Data recorded with your camera is stored in the following formats. Make sure that applications that support these file formats are installed on your computer.

- Image (except TEXT mode) : JPEG format
- Image in TEXT mode : GIF format.

Recommended OS/applications

OS

Windows 3.1, Windows 95, Windows 98, Windows 98SE, Windows Me, Windows 2000 Professional, Windows NT 3.51, Windows NT 4.0, etc.

Applications

Microsoft Internet Explorer 4.0 or higher, Netscape Navigator, etc.

To display the image list, double-click [Mavica.htm] in the floppy disk used with this camera as a medium for recording if you have installed a browser such as Microsoft Internet Explorer on your computer.

Notes

- For Macintosh, you can use the floppy disk recorded with this camera using PC Exchange with Mac OS system 7.5 or higher. A viewing application for Macintosh is also necessary for viewing images.
- When using the MSAC-FD2M/FD2MA Floppy Disk Adaptor for Memory Stick (not supplied), the recommended OS is Windows 95, Windows 98, Windows 98SE, Windows Me, Windows NT 4.0, Windows 2000 Professional or Mac OS 7.6.1 – 8.6.

-
- Microsoft and Windows, Windows NT are either registered trademarks or trademarks of Microsoft Corporation in the United States and/or other countries.
 - Macintosh and Mac OS are either registered trademarks or trademarks of Apple Computer, Inc.
 - All other product names mentioned herein may be the trademarks or registered trademarks of their respective companies.
Furthermore, “™” and “®” are not mentioned in each case in this manual.

Viewing images

For Windows 98 users



- 1 Start up your computer and insert the floppy disk into the disk drive of your computer.
- 2 Open [ My Computer] and double-click [ 3 1/2 Floppy (A:)].
- 3 Double-click the desired data file.

Image file storage destinations and image file names

Image files recorded with your camera are grouped in folders by recording mode. Images in a floppy disk and ones in a “Memory Stick” have different file names. The meanings of the file names are as follows.

When using floppy disks

□□□ stands for any number within the range from 001 to 999.

△ stands for one of the following characters below.

S: Image file recorded at 640×480 size

F: Image file of more than 640×480 size

For Windows 98 users (The drive recognizing the floppy disk is [A:].)

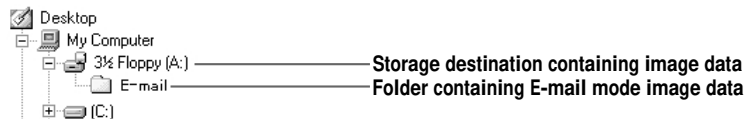

Location	File	Meaning
3 1/2 Floppy [A:]	MVC-□□□△.JPG	<ul style="list-style-type: none">Image file recorded normallyImage file recorded in E-MAIL mode (page 34)
	MVC-□□□△.411	<ul style="list-style-type: none">INDEX display file This file can only be played back on your camera.
	MVC-□□□T.GIF	<ul style="list-style-type: none">Image file recorded in TEXT mode (page 34)
E-mail folder	MVC-□□□E.JPG	<ul style="list-style-type: none">Small-size image file recorded in E-MAIL mode (page 34)

- The numerical portions of the following files are the same.
 - An image file recorded in E-MAIL mode and its corresponding small-size image file
- INDEX display files cannot be played back on other equipment.

When using “Memory Stick”s

□□□□ stands for any number within the range from 0001 to 9999.

For Windows 98 users (The drive recognizing the Floppy Disk Adaptor for Memory Stick is [A].)

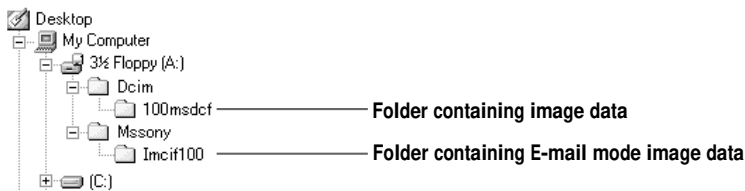

Folder	File	Meaning
100msdcf	DSC0□□□□.JPG	<ul style="list-style-type: none">• Image file recorded normally• Image file recorded in E-MAIL mode (page 34)
	TXT0□□□□.GIF	<ul style="list-style-type: none">• Image file recorded in TEXT mode (page 34)
Imcif 100	DSC0□□□□.JPG	<ul style="list-style-type: none">• Small-size image file recorded in E-MAIL mode (page 34)

The numerical portions of the following files are the same.

—An image file recorded in E-MAIL mode and its corresponding small-size image file

Tips

The digital still camera saves recorded images as digital data. The format of the saved data is called as the file format. The formats that can be used with this camera are as follows:

JPEG format

Most digital still cameras, operating systems of computers, and browser software adopt this format. This format is able to compress files without appreciable deterioration. However, if the image is compressed and saved on repeated occasions, the image will deteriorate. This camera records still images using the JPEG format for normal recording.

GIF format

Using this format, the image will not deteriorate even if the image is compressed and saved on repeated occasions. This format limits the number of colors to 256 colors. This camera records still images using the GIF format in TEXT mode (page 34).

Before performing advanced operations

This section describes the basic control methods that are frequently used for “Advanced operations.”

How to use the PLAY/STILL selector

The PLAY/STILL selector selects whether you can use your camera to record or play back and edit images. Set the selector as follows before starting to operate your camera.

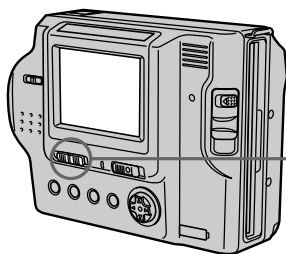

- PLAY:** To play back or edit images
- STILL:** To record images

How to use the control button

The control button is used to select the buttons, images and menus displayed on the LCD screen of your camera and modify the settings. The operation methods that are frequently used for “Advanced operations” are described below.

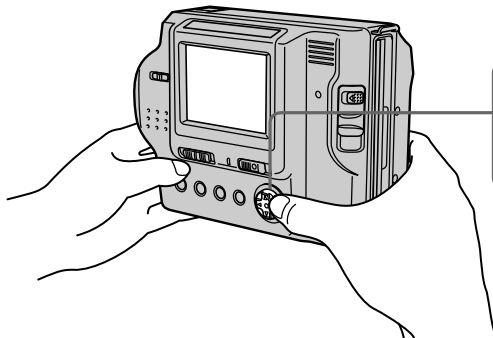

Select



Set (enter)



Turning on/off the operation buttons (menu bar) on the LCD screen



Press ▲ to display the menu bar on the LCD screen.

Press ▼ to clear the menu bar from the LCD screen.

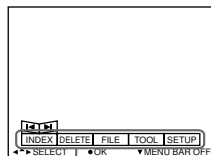

Menu bar

Note

You cannot clear the menu bar on the INDEX screen (page 41).

Selecting items or images on the LCD screen

- 1 Press ▲/▼/◀/▶ on the control button to select the item you want to set or the image you want to display.

The color of the selected item or the frame of the selected image changes from blue to yellow.

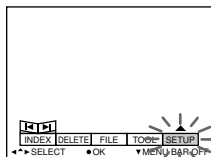

- 2 Press the center ● to enter the item.

Repeat steps 1 and 2 to execute each function.

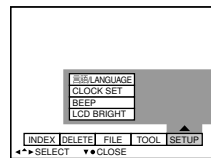

The “Advanced operations” section of this manual refers to selecting and entering items by the above procedure as “Select [item name].”

How to change the menu settings

Some of the advanced operations for your camera are executed by selecting menu items displayed on the LCD screen with the control button.

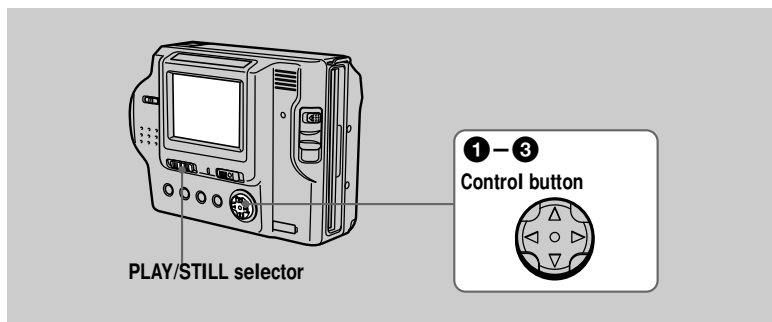

- 1 Press ▲ on the control button to display the menu bar.**
The menu bar appears as follows according to the position of the PLAY/STILL selector.

STILL

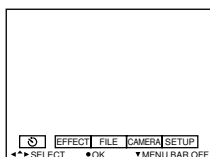

PLAY (single mode)

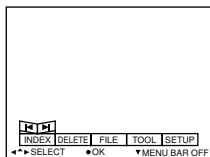

PLAY (INDEX mode)

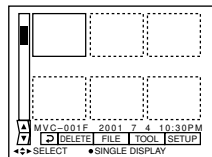

- 2 Select the desired item with ▲/▼/◀/▶ on the control button, then press the center ●.**
The color of the selected item changes from blue to yellow, and when you press the center ●, the settings that can be set for its item are displayed.

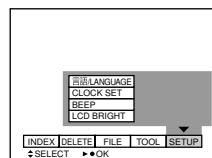

- 3 Select the desired setting with ▲/▼/◀/▶ on the control button, then press the center ●.**

To cancel the setup

Press ▼ on the control button repeatedly until the LCD screen returns to the menu bar display in step 1. To clear the menu bar, press ▼ again.

Menu settings

Menu items that can be modified differ depending on the position of the PLAY/STILL selector. The LCD screen shows only the items you can operate at the moment. Initial settings are indicated with ■.

(self-timer)

Records with the self-timer (page 19).

EFFECT

Item	Setting	Description	PLAY/STILL selector
P. EFFECT	SOLARIZE B&W SEPIA NEG.ART ■ OFF	Sets the image special effects (page 40).	STILL
DATE/ TIME	DAY & TIME DATE ■ OFF	Sets whether to insert the date and time into the image (page 40).	STILL

FILE

Item-1	Item-2	Setting	Description	PLAY/STILL selector
DISK TOOL	FORMAT	OK	Formats a floppy disk (page 50). Once you format a floppy disk, all of the data, including protected images are deleted. Be sure to check for images before you format a floppy disk.	PLAY STILL
		CANCEL	Cancels formatting of a floppy disk.	
	DISK COPY	OK	Copies all data stored in a floppy disk to another disk (page 48).	
		CANCEL	Cancels the disk copy.	
	CANCEL		Goes back to the [DISK TOOL] item.	

Item	Setting	Description	PLAY/STILL selector
FILE NUMBER	SERIES ■ NORMAL	Assigns numbers to files in sequence even if the floppy disk is changed. Resets the file number that starts from 001 each time the floppy disk is changed.	STILL
IMAGE SIZE	■ 1280×960 1280(3:2) 1024×768 640×480	Selects the image size when recording images.	STILL
REC MODE	TEXT E-MAIL ■ NORMAL	Records a GIF file in black-and-white. Records a small-size (320×240) JPEG file in addition to the selected image size. Records an image using the normal recording mode.	STILL
SLIDE SHOW (Only in PLAY (single mode))	INTERVAL REPEAT START CANCEL	Sets the slide show interval. ■ 3 sec/5 sec/10 sec/30 sec/1 min A slide show can be repeated for up to approx. 20 minutes. ■ ON/OFF Starts the slide show. Cancels the slide show settings or execution.	PLAY
PRINT MARK	ON ■ OFF	Marks the images to be printed (page 49). Unmarks the print mark of the images.	PLAY
PROTECT	ON ■ OFF	Protects images against accidental erasure (page 44). Releases protection of images.	PLAY

CAMERA

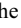
Item	Setting	Description	PLAY/STILL selector
DIGITAL ZOOM	■ ON OFF	Uses digital zoom. Does not use digital zoom.	STILL
SHARPNESS	+2 to -2	Adjusts the sharpness of the image. The  indicator appears (except when the setting is 0).	STILL

Item	Setting	Description	PLAY/STILL selector
WHITE BALANCE	IN DOOR OUT DOOR HOLD ■AUTO	Sets the white balance (page 39).	STILL
FLASH LEVEL	HIGH ■NORMAL LOW	Makes the flash level higher than normal. Normal setting. Makes the flash level lower than normal.	STILL
EXPOSURE	+2.0EV to -2.0EV	Adjusts the exposure before recording.	STILL

TOOL

Item	Setting	Description	PLAY/STILL selector
COPY	OK CANCEL	Copies the images (page 46). Cancels copying of the image.	PLAY
RESIZE (Only in PLAY (single mode)	1280×960 1024×768 640×480 CANCEL	Changes the recorded image size (page 46).	PLAY

SETUP

Item	Setting	Description	PLAY/STILL selector
DEMO	■STBY/ON OFF	Displayed only when you use the AC power adaptor in STILL mode. When [ON] is selected, a demonstration will start if you do not operate your camera for about 10 minutes. To stop the demonstration, turn off your camera.	STILL
言語 / LANGUAGE	■ENGLISH 日本語 /JPN	Displays the menu items in English. Displays the menu items in Japanese.	PLAY STILL
CLOCK SET	—	Sets the date and time (page 13).	PLAY STILL

Item	Setting	Description	PLAY/STILL selector
BEEP	SHUTTER	Turns on the shutter beeps only. (The shutter beeps are heard when you press the shutter button.)	PLAY STILL
	■ ON	Turns on all the beeps (when you press the control button/shutter button).	
	OFF	Turns off all the beeps.	
LCD BRIGHT	■■■■■■■■■■	Adjusts the LCD screen brightness using +/- on the LCD screen.	PLAY STILL

INDEX (Only in PLAY (single) mode)

Displays six images at a time (PLAY (INDEX) mode).

DELETE (Only in PLAY (single) mode)

Setting	Description	PLAY/STILL selector
OK	Deletes the displayed image.	PLAY
CANCEL	Cancels deleting of the image.	

↶ (Return) (Only in PLAY (INDEX) mode)

Returns to PLAY (single) mode.

► Various recording

Setting the image size (IMAGE SIZE)

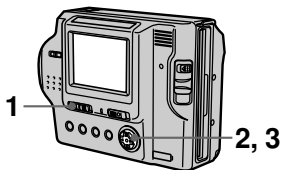

- 1 Set the PLAY/STILL selector to STILL.**
- 2 Select [FILE] and then [IMAGE SIZE] from the menu.**
- 3 Select the desired image size.**

1280×960, 1280 (3:2)*, 1024×768, 640×480

* The image is recorded in the ratio of three to two to fit the printing paper size. Using this image size, the margin of an image is not printed out. However, the slight amount of the upper and lower of the image being displayed on the LCD screen is not recorded.

The number of images that you can record on a floppy disk

Image size	Number of images*
1280×960	Approx. 6 (32)
1280 (3:2)	Approx. 6 (32)
1024×768	Approx. 10 (52)
640×480	Approx. 30 (159)

Numbers in parentheses indicate the numbers when you use the “Memory Stick” (8 MB) (not supplied).

* When REC MODE is set to NORMAL.

Note

If you try to record 55 images or more on a floppy disk, even if the remaining disk capacity is sufficient, “DISK FULL” appears on the LCD screen and you cannot record any more images.

Tips

The size of the image is indicated by the pixel unit. The higher number of pixels, the more information is included. So, an image that is saved using a large number of pixels is suitable for a large-format print and one that is saved using a smaller number of pixels is suitable for attaching to an E-mail. Normally, an image is recorded in the ratio of four to three to fit the monitor ratio. This camera can also record the image in the ratio of three to two to accommodate the most common printing paper size. This is the same ratio as the one used in photo-developing shops.



1280×960



1280 (3:2)

Recording images for e-mail (E-MAIL)

The E-MAIL mode records a small-size (320×240) image at the same time as a image. Small-size images are convenient for e-mail transmission, etc. Images in E-MAIL mode are recorded in the JPEG format.

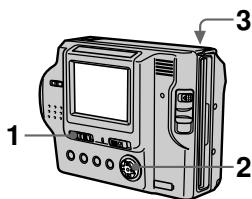

- 1 Set the PLAY/STILL selector to STILL.
- 2 Select [FILE], [REC MODE], and then [E-MAIL] from the menu.
- 3 Record the image.

The number of images that you can record on a floppy disk in E-MAIL mode

Image size	Number of images
1280×960	Approx. 5 (30)
1280 (3:2)	Approx. 5 (30)
1024×768	Approx. 8 (47)
640×480	Approx. 22 (120)

Numbers in parentheses indicate the numbers when you use the “Memory Stick” (8 MB) (not supplied).

To return to normal recording mode

Select [NORMAL] in step 2.

Recording text documents (TEXT)

Text is recorded in GIF format to provide a clear image.

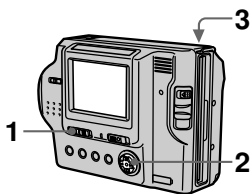

- 1 Set the PLAY/STILL selector to STILL.
- 2 Select [FILE], [REC MODE], and then [TEXT] from the menu.
- 3 Record the image.

The number of images that you can record on a floppy disk in TEXT mode

Image size	Number of images*
1280×960	Minimum 7 (40)
1280 (3:2)	Minimum 8 (44)
1024×768	Minimum 11 (61)
640×480	Minimum 28 (160)

Numbers in parentheses indicate the numbers when you use the “Memory Stick” (8 MB) (not supplied).

* The maximum number of recordable images depends on the document condition, such as the amount of text portions.

To return to normal recording mode

Select [NORMAL] in step 2.

Notes

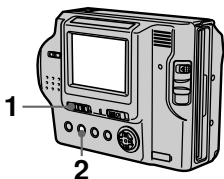

- If the subject is not evenly illuminated, you may be unable to record a clear image.
- Writing and reading data take more time than normal recording.

Recording images in macro



- 1 Set the **PLAY/STILL** selector to **STILL**.
- 2 Press **FOCUS** repeatedly until the  (macro) indicator appears on the LCD screen. With the zoom lever set to the **W** side, you can shoot a subject that is about 3 cm (1 3/16 inch) away from the lens surface in macro mode.

To return to normal recording mode

Press **FOCUS** repeatedly until both the  and  indicators disappear.



Notes

- You cannot record images in macro with the following **PROGRAM AE** modes:
 - Landscape mode
 - Panfocus mode
- You cannot record images in macro if the  indicator appears.

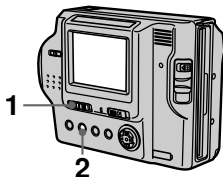

Setting the distance to the subject

Normally the focus is automatically adjusted. This function is useful when the auto focus does not work well such as in dark places.



- 1 Set the **PLAY/STILL** selector to **STILL**.
- 2 Press **FOCUS** repeatedly until a sharp focus is achieved. The  (manual focus) indicator appears on the LCD screen. You can select from six focus settings:  (macro), 0.5 m, 1.0 m, 3.0 m, 7.0 m, and ∞ (infinity)

To reactivate auto focusing

Press **FOCUS** repeatedly until both the  and  indicators disappear.

Notes

- Focal point information may not completely show the correct distance. Use the information as a guide.
- Focal point information does not show the correct distance when attaching the conversion lens.
- If you shoot a subject within 0.6 m (23 5/8 inches) while the zoom lever is set to **T** side, you cannot get a clear focus. In such cases, the focal point information flashes. Move the zoom lever to the **W** side until the indicator stops flashing.
- You cannot use this function if you have selected the Panfocus mode in the **PROGRAM AE** function.

Using the PROGRAM AE function

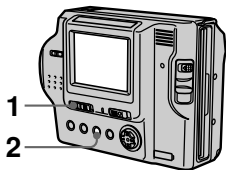

- 1 Set the PLAY/STILL selector to STILL.
- 2 Press PROGRAM AE repeatedly to select the desired PROGRAM AE mode.

Twilight mode

Suppresses the blurring of colors of a bright subject in a dark place so that you can record the subject without losing the dark atmosphere of the surroundings.

Twilight plus mode

Increases the effectiveness of the twilight mode function.

Landscape mode

Focuses only on a distant subject to record landscapes, etc.

Panfocus mode

Changes the focus quickly and simply from a close subject to a distant subject.

Spot light-metering mode

Select this mode when there is backlight or when there is strong contrast between the subject and the background, etc. Position the point you want to record at the spot light-metering cross hair.

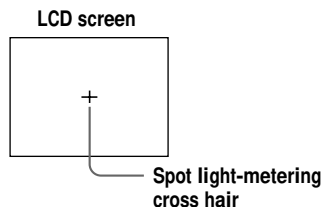

To cancel PROGRAM AE

Press PROGRAM AE repeatedly until the indicator on the LCD screen goes out.

Notes

- You can focus only on distant subjects in Landscape mode.
- In Panfocus mode, the zoom position is set to the W side and focus is fixed.
- When you record in Twilight plus mode, we recommend that you use a tripod to prevent shaking.
- Set the forced flash  when you use the flash in the following modes:
 - Twilight mode
 - Twilight plus mode
 - Landscape mode
- You cannot use the PROGRAM AE function when [REC MODE] is set to [TEXT].

Tips

Under normal recording conditions, the camera automatically makes various adjustments, such as those for the focus, iris, exposure, and white balance, as it shoots. However, you may not be able to carry out your desired shooting depending on shooting conditions. The program AE function provides you with near-optimum adjustments to suit your shooting situation.

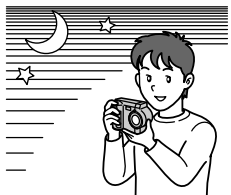

Adjusting the exposure (EXPOSURE)

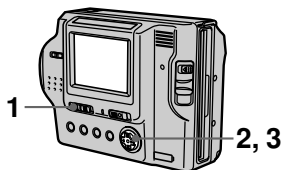

- 1 Set the PLAY/STILL selector to STILL.**
- 2 Select [CAMERA] and then [EXPOSURE] from the menu.**
- 3 Select the desired exposure value.**

Adjust the exposure value while checking the brightness of the background. You can select values ranging from +2.0 EV to -2.0 EV in steps of 1/3 EV.

Note

If a subject is under extremely bright or dark situations, or the flash is used, the exposure adjustment may not be effective.

Tips

Normally, the camera automatically adjusts the exposure. If the color of the image is too dark or bright as illustrated below, we recommend that you adjust the exposure manually. When the color of the image is too dark, set it toward +, and when it is too bright, set it toward -.

Set the exposure toward +



Set the exposure toward -



Adjusting the white balance (WHITE BALANCE)

Normally the white balance is automatically adjusted.

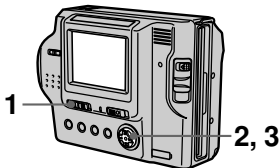

- 1** Set the **PLAY/STILL** selector to **STILL**.
- 2** Select **[CAMERA]** and then **[WHITE BALANCE]** from the menu.
- 3** Select the desired white balance setting.

IN DOOR (☀️)

- Places where the lighting condition changes quickly
- Under bright lighting such as photography studios
- Under sodium or mercury lamps

OUT DOOR (☀️)

Recording a sunrise/sunset, night scenes, neon signs, or fireworks

HOLD (HOLD)

Retains the adjusted white balance value

AUTO (No indicator)

Adjusts the white balance automatically

To reactivate auto adjustment

Select **[AUTO]** in step **3**.

Note

Select **[AUTO]** when shooting with fluorescent lighting.

Tips

The image is susceptible to lighting conditions. The image looks white under sunlight in the summer, and looks red under mercury lamps. Human eyes can resolve these problems. However, the camera cannot resolve the problem by making adjustments. Normally, the camera adjusts it automatically, but, if the image appears in strange colors, we recommend that you change the white balance mode.

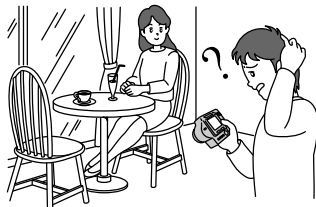

Recording the date and time on the image (DATE/TIME)

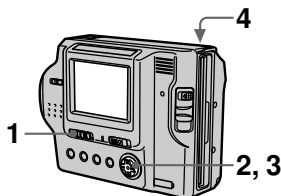

1 Set the PLAY/STILL selector to STILL.

2 Select [EFFECT] and then [DATE/TIME] from the menu.

3 Select the date and time.

DAY & TIME

Imposes the date, hour, and minute.

DATE

Imposes the year, month, and day.

OFF

Does not impose the date and time.

4 Record the image.

The date and time do not appear on the LCD screen during shooting. These appear during playback only.



Note

When [DATE] is selected in step 3, the date is imposed in the order set by the CLOCK SET item (page 13).

Enjoying picture effects (PICTURE EFFECT)

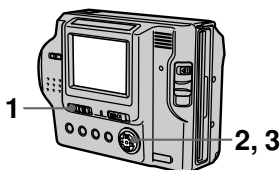

1 Set the PLAY/STILL selector to STILL.

2 Select [EFFECT] and then [P. EFFECT] from the menu.

3 Select the desired mode.

SOLARIZE

The light contrast is clearer and the picture looks like an illustration.

B&W

The picture is monochrome (black and white).

SEPIA

The picture is sepia-toned like an old photograph.

NEG.ART

The color and brightness of the picture are reversed as in a negative.

OFF

Does not use the picture effect function.

To cancel picture effect

Select [OFF] in step 3.

► Various playback

Playing back six images at once (INDEX)

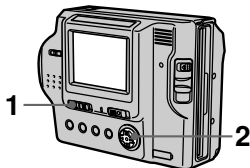

- 1 Set the **PLAY/STILL** selector to **PLAY**.
- 2 Select **[INDEX]** on the LCD screen.

Six images are displayed at once (index screen).

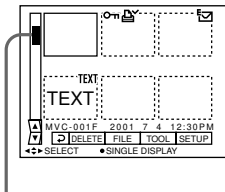

This shows the position of the currently displayed images relative to all the recorded images.

The following marks are displayed on each image according to the image type and settings.

: E-mail file

: Print mark

: Protect mark

TEXT: TEXT file

(No mark): Normal recording (no settings)

To display the next (previous) index screen

Select /▼ at the lower-left on the LCD screen.



Displays the previous index screen.

Displays the next index screen.

To return to normal playback (single image)

- Select the desired image with the control button.
- Select (Return).

Note

Images shot in TEXT mode cannot be displayed on the INDEX screen.

Enlarging a part of the image (Zoom and trimming)

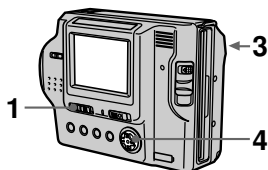

- 1 Set the PLAY/STILL selector to PLAY.**
- 2 Display the image to be enlarged.**
- 3 Zoom in/out the image with the zoom lever.**

The zoom scaling indicator appears on the LCD screen.
- 4 Press the control button repeatedly to select the desired portion of the image.**
 - ▲: The image moves downward
 - ▼: The image moves upward
 - ◀: The image moves rightward
 - ▶: The image moves leftward

To return to the normal size

Zoom out with the zoom lever until the zoom scaling indicator ($\times 1.1$) disappears from the screen, or simply press the center \bullet .

To record an enlarged image (trimming)

- ① Enlarge the image.
- ② Press the shutter button. The image is recorded at 640×480 size and the image on the LCD screen returns to the normal size after recording.

Notes

- You cannot trim the TEXT mode images.
- Zoom scaling is up to 5× regardless of the original image size.
- The quality of enlarged images may be deteriorated.
- The original data is left even if you enlarge the image.
- The enlarged image is recorded as the newest file.

Playing back the images in order (SLIDE SHOW)

This function is useful for checking the recorded images or for presentations, etc.

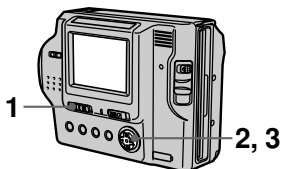

- 1 Set the PLAY/STILL selector to PLAY.**
- 2 Select [FILE] and then [SLIDE SHOW] from the menu.**

Set the following items.

INTERVAL

You can select from 1 min (one minute), 30 sec (30 seconds), 10 sec (10 seconds), 5 sec (5 seconds), or 3 sec (3 seconds).

REPEAT

ON: Plays back images in a continuous loop (approximately 20 minutes) until [RETURN] is selected.

OFF: After all images have been played back, the slide show ends.

- 3 Select [START].**
The slide show begins.

To cancel the slide show

Select [CANCEL] in step 2 or 3.

To skip to the next/previous image during the slide show

Select **◀▶** at the lower-left on the LCD screen.

Notes

- The interval setting time may vary depending on the image size.
- When [REPEAT] is set to [ON], the slide show does not end until all the images are played back, even if it takes more than 20 minutes.

► Editing

Preventing accidental erasure (PROTECT)

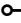
The  (protect) indicator appears on protected images.

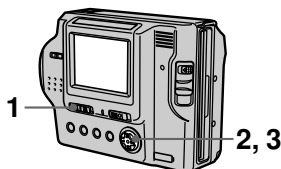

In single mode

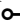
- 1 Set the PLAY/STILL selector to PLAY, then display the image to be protected.
- 2 Select [FILE], [PROTECT], and then [ON] from the menu. The displayed image is protected and the  indicator appears.

To release protection

Select [OFF] in step 2.

In INDEX mode

- 1 Set the PLAY/STILL selector to PLAY, then display the INDEX screen.
- 2 Select [FILE], [PROTECT], and then [ALL] or [SELECT] from the menu.

3 When you select [ALL]

Select [ON].

All the images in the floppy disk are protected.

When you select [SELECT]

Select all the images to be protected with the control button, then select [ENTER]. The selected images are protected.

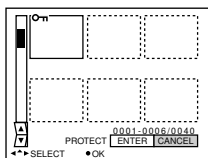

To release protection

If you selected [ALL] in step 2, select [OFF]. If you selected [SELECT] in step 2, select the images to be unprotected with the control button, then select [ENTER].

Deleting images (DELETE)

Protected images cannot be deleted.

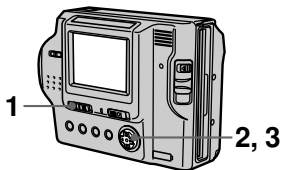

In single mode

- 1 Set the **PLAY/STILL** selector to **PLAY**, then display the image to be deleted.
- 2 Select **[DELETE]** and then **[OK]** from the menu.
The image is deleted.

In INDEX mode

- 1 Set the **PLAY/STILL** selector to **PLAY**, then display the **INDEX** screen.
- 2 Select **[DELETE]** and then **[ALL]** or **[SELECT]** from the menu.

3 When you select **[ALL]**

Select **[ENTER]**.

All the unprotected images are deleted.

When you select **[SELECT]**

Select all the images to be deleted with the control button, then select **[ENTER]**. The  (delete) indicator appears on the selected images and these images are deleted.

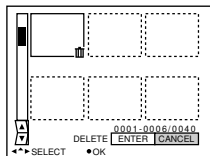

To cancel deleting

Select **[CANCEL]** in step 2 or 3.

Changing the recorded image size (RESIZE)

Use this function when you need a small-size image to attach it to an E-mail. The original image is retained even after resizing. The resized image is recorded as the newest file.

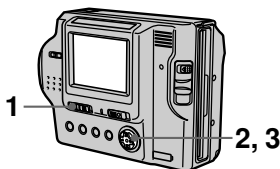

- 1 Set the PLAY/STILL selector to PLAY, then display the image of which you want to change the size.**
- 2 Select [TOOL] and then [RESIZE] from the menu.**
- 3 Select the desired size.**
1280×960, 1024×768, 640×480.
The resized image is recorded, then the display returns to the image display before resizing.

To cancel changing the size

Select [CANCEL] in step 3.

Notes

- You cannot change the size of images recorded in TEXT mode.
- When you change from a small size to a large size, the picture quality deteriorates.

Copying images (COPY)

Copies images to another floppy disk.

In single mode

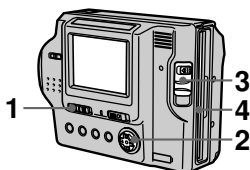

- 1 Set the PLAY/STILL selector to PLAY, then display the image to be copied.**
- 2 Select [TOOL], [COPY], and then [OK] from the menu.**
“DISK ACCESS” appears.
- 3 When “CHANGE FLOPPY DISK” appears, eject the floppy disk.**
“INSERT FLOPPY DISK” appears.
- 4 Insert another floppy disk.**
“RECORDING” appears. When copying is completed, “COMPLETE” appears.
To end copying, select [EXIT].

To continue copying the image to other floppy disks

After “COMPLETE” appears in step 4, select [CONTINUE] and repeat steps 3 and 4 above.



- 1 Set the PLAY/STILL selector to PLAY, then display the INDEX screen.**
- 2 Select [TOOL], [COPY], and then [ALL] or [SELECT] from the menu.**
- 3 When you select [ALL]**
Select [OK].
All the images are copied.
When you select [SELECT]
Select the images to be copied with the control button.
The ✓ mark appears on the images.
Select all the images to be copied, then select [ENTER].
“DISK ACCESS” appears.
- 4 When “CHANGE FLOPPY DISK” appears, eject the floppy disk.**
“INSERT FLOPPY DISK” appears.
- 5 Insert another floppy disk.**
“RECORDING” appears. When copying is completed, “COMPLETE” appears.
To end copying, select [EXIT].

To continue copying the image to other floppy disks

After “COMPLETE” appears in step 5, select [CONTINUE] and repeat steps 4 and 5 above.

To cancel copying partway

Change the PLAY/STILL selector position or turn off the power.

Note

If you eject and insert the floppy disk without selecting [EXIT] after “COMPLETE” appears, the image will be copied to the floppy disk.

Notes on the Floppy Disk Adaptor for Memory Stick (not supplied)

- You cannot select [ALL] when copying images in the “Memory Stick.”
- You cannot copy images from a floppy disk to a “Memory Stick.”
- When copying from a “Memory Stick” to a floppy disk, the file information (Exif tag) is not copied.

Copying all the information on your floppy disk (DISK COPY)

You can copy to another disk not only the images you have recorded with your camera but also various files you have created in other software with your computer.

Notes

- Once you carry out DISK COPY, all information saved on the recipient floppy disk is erased to be replaced by newly written data including the protected image data. Check the contents of the recipient disk before copying the disk.
- Be sure to use the floppy disk that has been formatted by this camera to carry out DISK COPY (page 50).

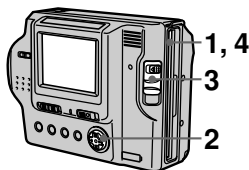

- 1 Insert the floppy disk to be copied.**
- 2 Select [FILE], [DISK TOOL], [DISK COPY], and then [OK] from the menu.**
“DISK ACCESS” appears.
- 3 When “CHANGE FLOPPY DISK” is displayed, eject the floppy disk.**
“INSERT FLOPPY DISK” appears.

- 4 Insert another floppy disk.**
“RECORDING” appears. When copying is completed, “COMPLETE” appears.
To end copying, select [EXIT].

To continue copying to other floppy disks

After “COMPLETE” appears in step 4, select [CONTINUE] and repeat steps 3 and 4 above.

To cancel copying partway

Change the PLAY/STILL selector position or turn off the power.

Note

If you eject and insert the floppy disk without selecting [EXIT] after “COMPLETE” appears, DISK COPY will be carried out onto the floppy disk.

Note on the Floppy Disk Adaptor for Memory Stick (not supplied)

You cannot do DISK COPY between “Memory Stick”s and floppy disks.

Selecting images to print (PRINT MARK)

You can mark a print mark on images recorded with your camera. This mark is convenient when you have images printed at a shop that conforms with the DPOF (Digital Print Order Format) standard.

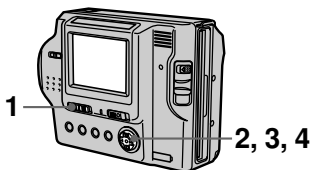

In single mode

- 1 Set the PLAY/STILL selector to PLAY and display the image you want to print.
- 2 Select [FILE], [PRINT MARK], and then [ON] from the menu. The  (print) mark is marked on the displayed image.

To unmark the print mark

Select [OFF] in step 2.

In INDEX mode

- 1 Set the PLAY/STILL selector to PLAY, then display the INDEX screen.
- 2 Select [FILE], [PRINT MARK], and then [SELECT] from the menu.
- 3 Select the images to be marked with the control button.

4 Select [ENTER].

The  marks on the selected images change from green to white.

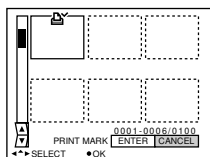

To unmark selected print marks

Select the images to be unmarked in step 3 with the control button, then select [ENTER].

To unmark all the print marks

Select [FILE], [PRINT MARK], [ALL], and then [OFF] from the menu. The  marks on all images are removed.

To print out using the FVP-1 Mavica Printer

Set PRESET SELECT SW to PC on the printer.

Note

You cannot mark a print mark on TEXT mode images.

Format

When you format a floppy disk, all data stored on the floppy disk will be deleted. Check the contents of the floppy disk before formatting.

Note

Even if images are protected, these images will be deleted.



- 1** Insert the floppy disk you want to format.
- 2** Select [FILE], [DISK TOOL], [FORMAT], and then [OK] from the menu.

To cancel formatting

Select [CANCEL] in step **2**.

Notes

- When you format the disk, be sure to use a fully charged battery pack or the AC power adaptor as the power source.
- If you use the Floppy Disk Adaptor for Memory Stick (not supplied), you can format "Memory Stick"s.

Additional information

Precautions

On cleaning

Cleaning the LCD screen

Wipe the screen surface with a cleaning cloth (not supplied) or an LCD cleaning kit (not supplied) to remove fingerprints, dust, etc.

Cleaning the camera surface

Clean the camera surface with a soft cloth slightly moistened with water, then wipe the surface dry. Do not use any type of solvent such as thinner, alcohol or benzene as this may damage the finish or the casing.

After using your camera at the seashore or other dusty locations

Clean your camera carefully. Otherwise, the salty air may corrode the metal fittings or dust may enter the inside of your camera, causing a malfunction.

On floppy disks

To protect data recorded on floppy disks, note the following:

- Avoid storing floppy disks near magnets or magnetic fields such as those of speakers and televisions. Otherwise, permanent erasure of disk data may result.
- Avoid storing floppy disks in areas subject to direct sunlight or sources of high temperature, such as a heating device. Floppy disk warping or damage may result, rendering the disk useless.
- Avoid contact with the disk's surface by opening the disk shutter plate. If the disk's surface becomes blemished, data may be rendered unreadable.

- Avoid getting liquids on the floppy disk.
- Be sure to use a floppy disk case to ensure protection of important data.
- Even when you use a 3.5 inch 2HD floppy disk, image data may not be recorded and/or displayed depending on the using environment. In this case, use a disk of other brand.

On operating temperature

Your camera is designed for use between the temperatures of 0°C to 40°C (32°F to 104°F). Recording in extremely cold or hot places that exceed this range is not recommended.

On moisture condensation

If the camera is brought directly from a cold to a warm location, or is placed in a very damp room, moisture may condense inside or outside the camera. Should this occur, the camera will not operate properly.

Moisture condensation occurs easily when:

- The camera is brought from a cold location such as a ski slope into a warmly heated room.
- The camera is taken from an air-conditioned room or car interior to the hot outdoors, etc.

How to prevent moisture condensation

When bringing the camera from a cold place to a warm place, seal the camera in a plastic bag and allow it to adapt to conditions at the new location over a period of time (about an hour).

If moisture condensation occurs

Immediately eject the floppy disk, then turn off the camera and wait about an hour for the moisture to evaporate. Note that if you attempt to record with moisture remaining inside the lens, you will be unable to record clear images.

On AC power adaptor

- Unplug the unit from the wall outlet (mains) when you are not using the unit for a long time. To disconnect the power cord (mains lead), pull it out by the plug. Never pull the power cord (mains lead) itself.
- Do not operate the unit with a damaged cord (mains lead) or if the unit has been dropped or damaged.
- Do not bend the power cord (mains lead) forcibly, or place a heavy object on it. This will damage the cord (mains lead) and may cause fire or electrical shock.
- Prevent metallic objects from coming into contact with the metal parts of the connecting section. If this happens, a short may occur and the unit may be damaged.
- Always keep metal contacts clean.
- Do not disassemble the unit.
- Do not apply mechanical shock or drop the unit.
- While the unit is in use, particularly during charging, keep it away from AM receivers and video equipment. AM receivers and video equipment disturb AM reception and video operation.
- The unit becomes warm during use. This is not a malfunction.
- Do not place the unit in locations that are:
 - Extremely hot or cold
 - Dusty or dirty
 - Very humid
 - Vibrating

On battery pack

- Use only the specified charger with the charging function.
- To prevent accident from a short circuit, do not allow metal objects to come into contact with the battery terminals.
- Keep the battery pack away from fire.
- Never expose the battery pack to temperatures above 60°C (140°F), such as in a car parked in the sun or under direct sunlight.
- Keep the battery pack dry.
- Do not expose the battery pack to any mechanical shock.
- Do not disassemble nor modify the battery pack.
- Attach the battery pack to the camera securely.
- Charging while some capacity remains does not affect the original battery capacity.

On the built-in rechargeable lithium battery

Your camera is supplied with a built-in rechargeable lithium battery installed so as to retain the date and time, etc., regardless of the setting of the POWER switch. The built-in rechargeable lithium battery is always charged as long as you are using your camera. The battery, however, will get discharged gradually if you do not use your camera. It will be completely discharged in about six months if you do not use your camera at all. Even if the built-in rechargeable lithium battery is not charged, it will not affect the camera operation. To retain the date and time, etc., charge the battery if the battery is discharged.

Charging the built-in rechargeable lithium battery:

- Connect your camera to house current (mains) using the AC power adaptor supplied with your camera, and leave your camera with the power turned off for more than 24 hours.
- Or install the fully charged battery pack in your camera, and leave your camera with the power turned off for more than 24 hours.

If any problem occurs, unplug your camera and contact your nearest Sony dealer.



On “Memory Sticks”

“Memory Stick” is a new compact, portable and versatile IC recording medium with a data capacity that exceeds a floppy disk. “Memory Stick” is specially designed for exchanging and sharing digital data among “Memory Stick” compatible products. Because it is removable, “Memory Stick” can also be used for external data storage.

There are two types of “Memory Sticks”: general “Memory Sticks” and “MagicGate Memory Sticks” that are equipped with the MagicGate* copyright protection technology. You can use both types of “Memory Stick” with your camera. However, because your camera does not support the MagicGate standards, data recorded with your camera is not subject to MagicGate copyright protection.

* MagicGate is copyright protection technology that uses encryption technology.

Notes

- Do not remove the “Memory Stick” while reading or writing data.
 - Data may be damaged if:
 - you remove the “Memory Stick” or turn off your camera while reading or writing data.
 - you use the “Memory Stick” in a location subject to the effects of static electricity or noise.
 - Do not attach any other material than the supplied label on the labeling position.
 - When you carry or store the “Memory Stick,” put it in its supplied case.
 - Do not touch the terminals of a “Memory Stick” with your hand or a metal object.
 - Do not strike, bend or drop the “Memory Stick.”
 - Do not disassemble or modify the “Memory Stick.”
 - Do not allow the “Memory Stick” to get wet.
- “Memory Stick”, , “MagicGate Memory Stick” and  are trademarks of Sony Corporation. “MagicGate” and **MAGICGATE** are trademarks of Sony Corporation.

Using your camera abroad

Power sources

You can use your camera in any country or area with the supplied battery charger within 100 V to 240 V AC, 50/60 Hz. Use a commercially available AC plug adaptor [a], if necessary, depending on the design of the wall outlet (mains) [b].

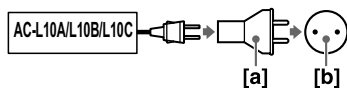

About “InfoLITHIUM” battery pack

What is the “InfoLITHIUM” battery pack?

The “InfoLITHIUM” battery pack is a lithium-ion battery pack that has functions for communicating information related to operating conditions between your camera and the AC power adaptor.

The “InfoLITHIUM” battery pack calculates the power consumption according to the operating conditions of your camera, and displays the remaining battery time in minutes.

Charging the battery pack

- Be sure to charge the battery pack before you start using your camera.
- We recommend charging the battery pack in an ambient temperature of between 10°C to 30°C (50°F to 86°F) until the POWER ON/OFF (CHG) lamp goes out, indicating that the battery pack is fully charged. If you charge the battery pack outside of this temperature range, you may not be able to efficiently charge the battery pack.
- After charging is completed, either disconnect the AC power adaptor from the DC IN jack on your camera or remove the battery pack.

Effective use of the battery pack

- Battery performance decreases in low-temperature surroundings. So, the time that the battery pack can be used is shorter in cold places. We recommend the following to use the battery pack longer:
 - Put the battery pack in a pocket close to your body to warm it up, and insert it in your camera immediately before you start taking shots.
 - Use the large capacity battery pack (NP-F550, optional).
- Frequently using the LCD panel or frequently operating the zoom wears out the battery pack faster. We recommend using the large capacity battery pack (NP-F550, optional).
- Be certain to turn the POWER switch to off when not taking shots or playing back on your camera.
- We recommend have spare batteries handy for two or three times the expected shooting time, and make a trial shots before taking the actual shots.
- Do not expose the battery pack to water. The battery pack is not water-resistant.

Remaining battery time indicator

- If the power goes off although the battery remaining indicator indicates that the battery pack has enough power to operate, charge the battery pack fully again so that the indication on the battery remaining indicator is correct. Note, however, that the correct battery indication sometimes will not be restored if it is used in high temperatures for a long time or left in a fully charged state, or the battery pack is frequently used. Regard the remaining battery time indication as the approximate shooting time.

- The  mark indicating there is little remaining battery time sometimes flashes depending on the operating conditions or ambient temperature and environment even if the remaining battery time is 5 to 10 minutes.

How to store the battery pack

- Even if the battery pack is not used for a long time, store it in a dry, cool place after fully charging it once per year and then using the battery pack up on your camera. This is to maintain the battery pack's functions.
- To use the battery pack up on your camera, leave the POWER switch to on in PLAY mode until the power goes off without a floppy disk or a "Memory Stick" inserted.





Battery life

- The battery life is limited. Battery capacity decreases little by little as you use it more and more, and as time passes. When the battery operating time is shortened considerably, a probable cause is that the battery pack has reached the end of its life. Please buy a new battery pack.
- The battery life varies according to how it is stored and operating conditions and environment for each battery pack.

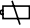
Troubleshooting

If you experience trouble with your camera, first check the following items. Should your camera still not operate properly after you have made these checks, consult your Sony dealer or local authorized Sony service facility. **If code displays (C: □□:□□) appear on the LCD screen, the self-diagnosis display function is working (page 62).**

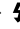
Symptom	Cause and/or Solution
Your camera does not work.	<ul style="list-style-type: none">• You are not using an “InfoLITHIUM” battery pack. →Use an “InfoLITHIUM” battery pack (page 9).• The floppy disk is not inserted properly. →Eject the disk, and insert it again (page 15).• The battery level is too low. (The  indicator appears.) →Charge the battery pack fully (page 10).• The AC power adaptor is not connected securely. →Connect it securely to the DC IN jack and a wall outlet (mains) (page 10, 12).• The malfunction occurs inside the camera. →Turn off the power, and turn on after one minute, then check that the camera works properly.
Your camera cannot record images.	<ul style="list-style-type: none">• The PLAY/STILL selector is set to PLAY. →Set it to STILL (page 16).• No floppy disk is inserted into your camera. →Insert a floppy disk (page 15).• The tab on the disk is set to the unrecordable position. →Set it to the recording position (page 15).
The picture is out of focus.	<ul style="list-style-type: none">• Your camera is not in macro recording mode when you shoot a subject that is about 3 to 25 cm (1 3/16 to 9 7/8 inches) away from the lens. →Set the macro recording mode (page 35). →Move the zoom lever to the W side.
The picture is noisy.	<ul style="list-style-type: none">• Your camera is placed near a TV or other equipment that uses strong magnets. →Move your camera away from the TV, etc.

Symptom	Cause and/or Solution
The picture is too dark.	<ul style="list-style-type: none"> You are shooting a subject with a light source behind the subject. → Adjust the exposure (page 38). The brightness of the LCD screen is too low. → Adjust the brightness of the LCD screen (page 18).
The flash does not work.	<ul style="list-style-type: none"> The flash is set to . → Set the flash to (no indication), , or  (page 20). The camera is in one of the following PROGRAM AE modes: Twilight, Twilight plus, or Landscape. → Cancel the PROGRAM AE function or set the flash to  (page 20, 36).
The date and time are recorded incorrectly.	<ul style="list-style-type: none"> The date and time are not set correctly. → Set the correct date and time (page 13).
Vertical streaks appear when you are shooting a very bright subject.	<ul style="list-style-type: none"> This is called the smear phenomenon. → This is not a malfunction.
The read/write time is slow when using a "Memory Stick."	<ul style="list-style-type: none"> When using the Floppy Disk Adaptor for Memory Stick, writing and reading images take about twice times than using a floppy disk. → This is not a malfunction.
The zoom does not work.	<ul style="list-style-type: none"> PROGRAM AE is set to the Panfocus mode. → Cancel the Panfocus mode (page 36).
Digital zoom does not function.	<ul style="list-style-type: none"> Digital zoom is set to [OFF]. → Set digital zoom to [ON] at the menu.
The image is in monochrome.	<ul style="list-style-type: none"> You shot the image in TEXT mode. → Cancel the TEXT mode (page 34). The picture effect is set to B&W. → Cancel the B&W mode (page 40).
The image cannot be played back on a computer.	<ul style="list-style-type: none"> → Consult the computer or software manufacturer.
Your camera cannot delete an image.	<ul style="list-style-type: none"> The image is protected. → Cancel the protection (page 44).

Symptom	Cause and/or Solution
The power turns off suddenly.	<ul style="list-style-type: none"> • With the PLAY/STILL selector set to STILL, if you do not operate the camera for about three minutes while the power is on, the camera turns off automatically to prevent wearing down the battery pack. <ul style="list-style-type: none"> → Turn on the camera. • The battery pack is discharged. <ul style="list-style-type: none"> → Replace it with a fully charged battery pack.
The slide show function stops automatically.	<ul style="list-style-type: none"> • The slide show function stops after about 20 minutes. <ul style="list-style-type: none"> → To continue the slide show, select [START] again (page 43).
You cannot use the PROGRAM AE function.	<ul style="list-style-type: none"> • The camera is set to TEXT mode. <ul style="list-style-type: none"> → Cancel the TEXT mode (page 34).
The macro function does not work.	<ul style="list-style-type: none"> • PROGRAM AE is set to the Panfocus mode. <ul style="list-style-type: none"> → Cancel the Panfocus mode (page 36).
You cannot resize the image.	<ul style="list-style-type: none"> • This function does not work on a TEXT image.
You cannot mark an image with the print mark.	<ul style="list-style-type: none"> • The print mark cannot be marked on a TEXT image.



Battery packs



Symptom	Cause and/or Solution
The battery pack cannot be charged.	<ul style="list-style-type: none"> • The power of the camera is turned on. <ul style="list-style-type: none"> → Turn off the power of the camera (page 10).
The battery life is short.	<ul style="list-style-type: none"> • You are recording/playing back images under extremely cold temperatures. • The battery pack is not charged enough. <ul style="list-style-type: none"> → Charge the battery pack fully. • The battery pack is dead. <ul style="list-style-type: none"> → Replace the battery pack with a new one.

Symptom	Cause and/or Solution
<p>The indication of the battery remaining time is not proper, or the power is immediately turned off even if the battery remaining indicator indicates that the battery level is sufficient.</p>	<ul style="list-style-type: none"> • You are using the camera for many hours under extremely hot or cold temperatures. • The battery pack is dead. → Replace the battery pack with a new one (page 9). • The battery level is too low. → Install the fully charged battery pack (page 9, 10) • A deviation has occurred in the remaining battery time. → Charge the battery pack fully (page 10).
<p>The POWER ON/OFF (CHG) lamp flashes when charging a battery pack.</p>	<ul style="list-style-type: none"> • A malfunction has occurred in the battery pack. → Contact your Sony dealer or local authorized Sony service facility.
<p>The POWER ON/OFF (CHG) lamp does not light up when charging a battery pack.</p>	<ul style="list-style-type: none"> • The AC power adaptor is not connected. → Connect the power cord firmly to a wall outlet (page 10). • The battery pack is not installed properly. → Install it properly (page 9). • Charging of the battery pack is complete.

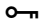
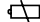
Warning and notice messages

Various messages appear on the LCD screen. Check the corresponding descriptions in the following list.

Message	Meaning
DRIVE ERROR	There is trouble with the disk drive.
NO DISK	No disk is inserted.
FORMAT ERROR	<ul style="list-style-type: none">• The floppy disk loaded is not MS-DOS formatted (512 bytes×18 sectors).• The battery level of the Floppy Disk Adaptor for Memory Stick is low.
DISK PROTECT	The tab on the disk is set to the unrecordable position.
DISK FULL	The disk is full.
NO FILE	No image is recorded on the disk.
FILE ERROR	Trouble has occurred during playback.
FILE PROTECT	The image is protected.
DISK ERROR	A 2DD floppy disk is inserted, or there is trouble with the disk.
NOT ENOUGH MEMORY	The remaining capacity of the floppy disk is not enough to copy the image.
IMAGE SIZE OVER	You tried to play back images with an image size larger than the maximum playback size of this camera.
INVALID OPERATION	<ul style="list-style-type: none">• You attempted to carry out DISK COPY when using the Floppy Disk Adaptor for Memory Stick.• You select [ALL] from [COPY] when using the Floppy Disk Adaptor for Memory Stick.
for “InfoLITHIUM” battery only	The battery is not the “InfoLITHIUM” type.
	The image is protected.
	The battery level is too low. When the remaining time is about 5 to 10 minutes,  may flash depending on the battery pack used, operating conditions, or the environment.
NOT ENOUGH FD ADAPTOR'S BATTERY	The battery level of the Floppy Disk Adaptor for Memory Stick is low.

Message	Meaning
 COULDN'T RECORD	The battery level of the Floppy Disk Adaptor for Memory Stick is too low to shoot.
 INVALID OPERATION	The battery level of the Floppy Disk Adaptor for Memory Stick is too low to do some operations.
 DISK ERROR	<ul style="list-style-type: none"> • The battery level of the Floppy Disk Adaptor for Memory Stick is too low to operate. • Trouble has occurred on the Floppy Disk Adaptor for Memory Stick.

Self-diagnosis display

Your camera has a self-diagnosis display. This function displays the camera condition on the LCD screen with a combination of a letter and four digits of numbers. If this appears, check the following code chart. The code informs you of the camera's current condition. The last two digits (indicated by □□) will differ depending on the state of the camera.



Self-diagnosis display

- C: □□: □□

You can repair the camera yourself.

- E: □□: □□

Contact your Sony dealer or local authorized Sony service facility.

Code	Cause and/or Corrective Action
C:32:□□	<ul style="list-style-type: none">• There is trouble with the disk drive. → Turn the power off and on again.
C:13:□□	<ul style="list-style-type: none">• An unformatted floppy disk is inserted. → Format the floppy disk. (page 50)• A disk not compatible with this camera is inserted. → Change the disk. (page 15)• The battery level of the Floppy Disk Adaptor for Memory Stick is too low. → Replace the battery with a new one.
E:61:□□ E:91:□□	<ul style="list-style-type: none">• A camera malfunction that you cannot repair has occurred. → Contact your Sony dealer or local authorized Sony service facility and inform them of the 5-digit indication. (example: E:61:10)

If you are unable to rectify the problem even if you try corrective actions a few times when C:□□:□□ is indicated, contact your Sony dealer or local authorized Sony service facility.

Specifications

System

Image device

6.64 mm (1/2.7 type) color
CCD

Lens

3× zoom lens
f = 6.1 – 18.3 mm (1/4 –
3/4 inches)
(39 – 117 mm (1 9/16 –
4 5/8 inches) when
converted into a 35 mm still
camera)
F = 2.8 – 2.9

Exposure control

Automatic exposure

White balance

Automatic, Indoor, Outdoor,
Hold

Data compression system

GIF (in TEXT mode)
Floppy disk: JPEG (JFIF)
“Memory Stick”: JPEG
(Exif2.1)

Recording medium

Floppy disk:
3.5 inch 2HD MS-DOS
format (1.44 MB)
“Memory Stick” (When
using with the MSAC-
FD2M/FD2MA Floppy Disk
Adaptor for Memory Stick):
DCF format

Flash

Recommended recording
distance:
0.3 m to 2.5 m (11 7/8 inches
to 8 1/3 feet)

LCD screen

LCD panel

TFT (Thin Film Transistor
active matrix) drive

Total number of dots

123 200 (560×220) dots

General

Application

Sony battery pack NP-F330
(supplied)/F550

Power requirements

8.4 V

Power consumption (During shooting)

3.5 W

Operating temperature

0°C to 40°C (32°F to 104°F)

Storage temperature

–20°C to +60°C (–4°F to
+140°F)

Dimensions (Approx.)

143×103×75 mm
(5 3/4×4 1/8×3 inches) (w/h/
d)

Mass (Approx.)

630 g (1 lb 6 oz) (including
NP-F330 battery pack,
floppy disk and lens cap,
etc.)

AC-L10A/L10B/L10C

AC power adaptor

Power requirements

100 to 240 V AC, 50/60 Hz

Rated output voltage

DC 8.4 V, 1.5 A in operating
mode

Operating temperature

0°C to 40°C (32°F to 104°F)

Storage temperature

–20°C to +60°C (–4°F to
+140°F)

Dimensions (Approx.)

125×39×62 mm (5×1 9/16×
2 1/2 inches) (w/h/d)

Mass (Approx.)

280 g (10 oz)

NP-F330 battery pack

Battery type

Lithium ion

Maximum output voltage

DC 8.4 V

Mean output voltage

DC 7.2 V

Capacity

5.0 Wh (700 mAh)

Operating temperature

0°C to 40°C (32°F to 104°F)

Dimension (Approx.)

38.4×20.6×70.8 mm
(1 9/16×13/16×2 7/8 inches)
(w/h/d)

Mass (Approx.)

70 g (2 oz)

Accessories

AC-L10A/L10B/L10C

AC power adaptor (1)

Power cord (mains lead) (1)

NP-F330 battery pack (1)

Shoulder strap (1)

CD-ROM (1)

Lens cap (1)

Lens cap strap (1)

Operating instructions (1)

Design and specifications
are subject to change
without notice.

LCD screen indicators

The indicators during recording

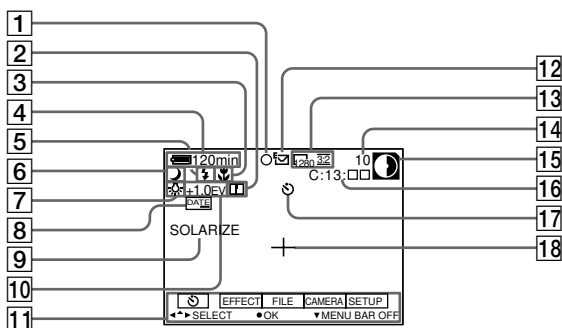

- 1 AE lock indicator/Focus lock indicator
- 2 Sharpness indicator
- 3 Focus mode indicator/Macro indicator
- 4 Battery remaining indicator
- 5 Flash level indicator/Flash mode indicator
- 6 PROGRAM AE indicator/Zoom indicator
- 7 White balance indicator
- 8 DATE/TIME indicator
- 9 Picture effect indicator
- 10 EV level indicator
- 11 Menu bar and guide menu
They appear by pressing ▲ on the control button and disappear by pressing ▼.
- 12 Recording mode indicator
- 13 Image size indicator
- 14 Number of recorded images
- 15 Remaining disk capacity indicator
- 16 Self-diagnosis function indicator
- 17 Self-timer indicator
- 18 Spot light-metering indicator

The indicators during playback

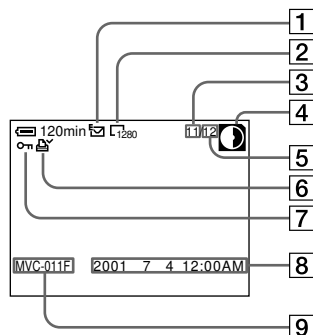

- 1 Recording mode indicator
- 2 Image size indicator
- 3 Image number
- 4 Remaining disk capacity indicator
- 5 Number of stored images on a floppy disk
- 6 Print mark indicator
- 7 Protect indicator/Zoom scaling indicator
- 8 Recording date of the playback image*
- 9 File name*

* When the menu bar is displayed, this indicator disappears from the screen.

Index

A

- AC power adaptor.. 10, 12
- Adjusting brightness
 - Image.....38
 - LCD screen.....18
- AE (auto exposure).....16
- Auto power-off function.....11

B

- Battery pack
 - Charging.....10
 - Installing.....9
 - Remaining time.....10
 - Usable time.....11
- BEEP.....32

C

- Charging.....10
- Cleaning.....51
- CLOCK SET.....13
- Control button.....26
- COPY.....46

D

- DELETE.....45
- DEMO.....31
- DIGITAL ZOOM.. 19, 30
- DISK COPY.....48
- DISK TOOL.....29
- DPOF.....49

E

- Editing
 - COPY.....46
 - DELETE.....45
 - PROTECT.....44
- E-MAIL.....34

F

- FILE NUMBER.....30
- FLASH LEVEL.....31
- Floppy disk
 - Copying.....48
 - Format.....50
 - Inserting.....15
 - Number of recordable images..... 33, 34
 - Usable type.....15
- FORMAT.....50
- Full charge.....10

G

- GIF..... 22, 25, 34

I

- Image
 - Copying.....46
 - Deleting.....45
 - File name.....24
 - Playback.....21
 - Print mark.....49
 - Protect.....44
 - Recording.....16
 - Size.....33
- INDEX screen.....41
- Indicators on the LCD screen.....64
- “InfoLITHIUM” battery pack.....54

J

- JPEG..... 16, 22, 25

M

- Macro recording.....35
- Manual focusing.....35
- Menu.....28
- Moisture condensation...51

N

- Number of recordable images
 - Battery pack.....11
 - E-mail mode.....34
 - Image size.....33
 - TEXT mode.....34

P

- PICTURE EFFECT.....40
- PLAY/STILL selector...26
- Playing back
 - Images.....21
 - INDEX screen.....41
 - Slide show.....43
 - Viewing images on a computer.....22
- Power source
 - AC power adaptor.....12
 - Battery pack.....9
- PRINT MARK.....49
- PROGRAM AE.....36
- PROTECT.....44

R

- REC MODE.....30
- Recording
 - E-mail mode.....34
 - Image.....16
 - In macro.....35
 - TEXT mode.....34
 - With flash.....20
- RESIZE.....46

S

- Self timer.....19

- Self-diagnosis display....62
- Setting the date and time.....13
- Single display.....41
- SLIDE SHOW.....43

T

- TEXT mode.....34

U

- Using flash.....20
- Using your camera abroad.....53

V

- Viewing images using a computer.....22

W

- Warning messages.....60
- WHITE BALANCE.....39

Z

- Zoom.....18

Sony **on**line

<http://www.world.sony.com/>

Printed on recycled paper
Printed using vegetable oil ink with less
than 1% VOC (Volatile Organic
Compound).

Sony Corporation Printed in Japan



3 0 6 6 7 4 1 1 1